



MAGIC MOVE

- Full extension, fully synchronized runner
- 40kg load capacity
- Zinc plated finish
- Drawer system self locks once positioned on slide
- Soft closing
- Bottom mounting
- 3D adjustment
Up/down adjustment 0-2.5 mm
Left/right adjustment ± 1.5 mm
Depth adjustment 0-3mm
- Includes 3D front brackets with runners
- Maximum drawer side thickness: 16mm

Nominal Length	Magic Move
250 mm	DTCTS10250H
300 mm	DTCTS10300H
350 mm	DTCTS10350H
400 mm	DTCTS10400H
450 mm	DTCTS10450H
500 mm	DTCTS10500H
550 mm	DTCTS10550H
600 mm	DTCTS10600H

features

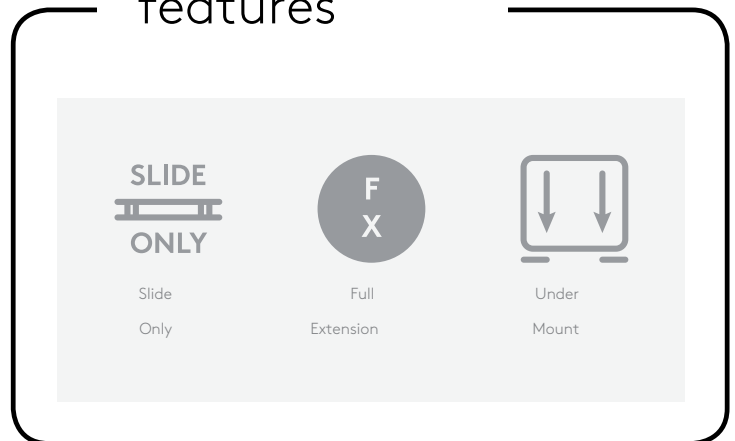

advantages

- 3D adjustable for a better retro-fitting of drawers
- Soft closing without additional parts
- Fully concealed runner
- No rebate required to accommodate runner

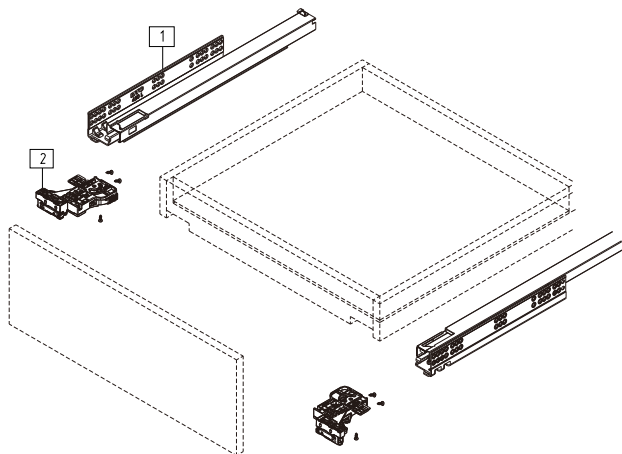

Installation dimensions

NL=Nominal Slide Length
 LT=Internal Cabinet Depth
 LT=NL+3

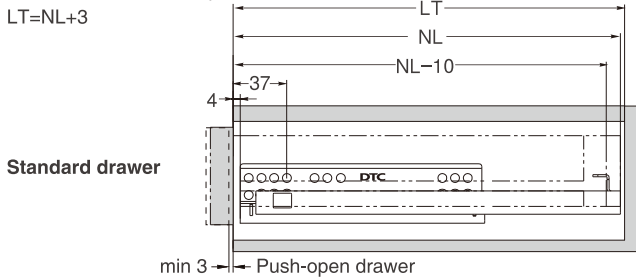

NL=Nominal Slide Length
 LT=Internal Cabinet Depth
 LT=NL+21

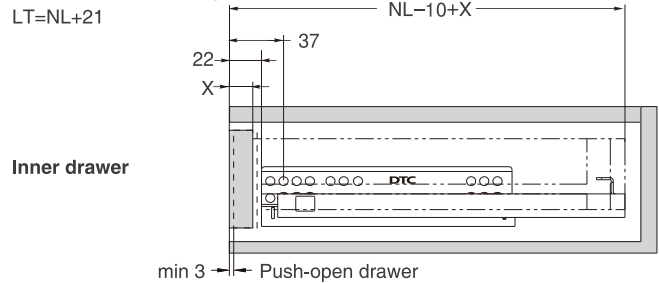

Screw position of the slides (mm)

Cabinet edge	Slide	NL
99	DTC 250 L	250
99	DTC 270 L	270
99	DTC 300 L	300
99	DTC 320 L	320
99	DTC 350 L	350
99	DTC 380 L	380
99	DTC 400 L	400
99	DTC 420 L	420
99	DTC 450 L	450
99	DTC 480 L	480
99	DTC 500 L	500
99	DTC 520 L	520
99	DTC 550 L	550
99	DTC 600 L	600

Slide	Dimensions
DTC 250 L	32, 96, 128, 160, 192, 224, 256
DTC 270 L	36, 44, 74

37 ← Fourth hole

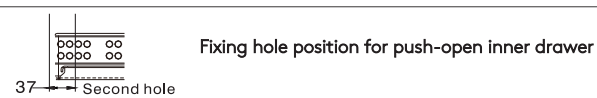

Installation dimensions

SKW= Internal Drawer Width
 LW= Internal Cabinet Width

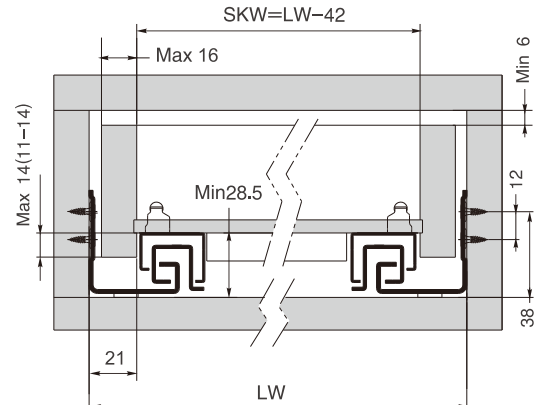

Drawer back preparation (mm)

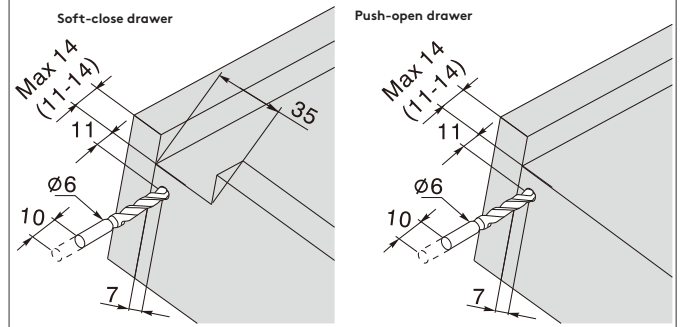

Locking device installation (mm)

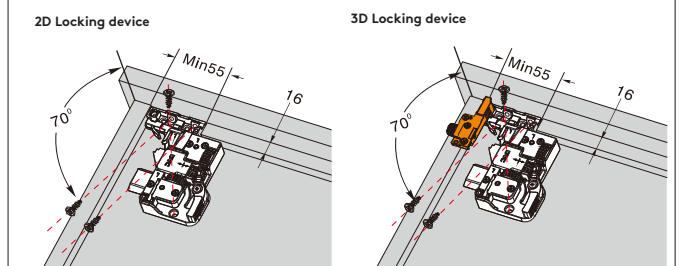

Drawer Assembly with 3D Adjustment Locking Device

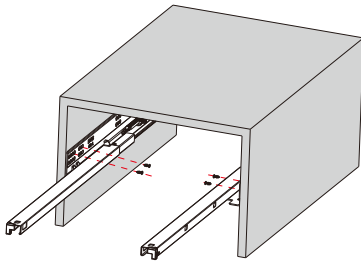

Fix the slide on the cabinet.

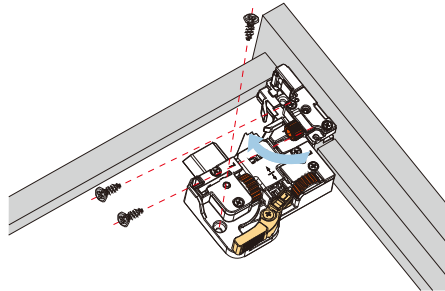

Move out the adjusting part and fix the locking device on the drawer bottom. Put the adjusting part back and tighten the screws.

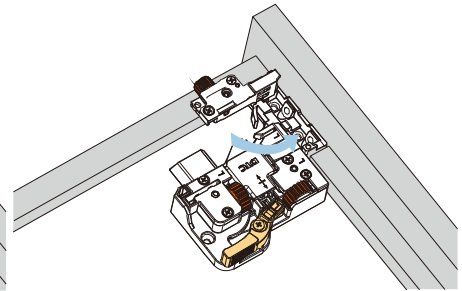

Drawer Assembly with 3D Adjustment Locking Device

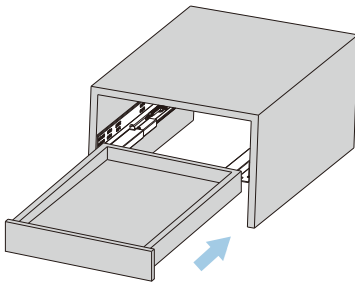

Lay the drawer bottom onto the slide then push the drawer into the cabinet.

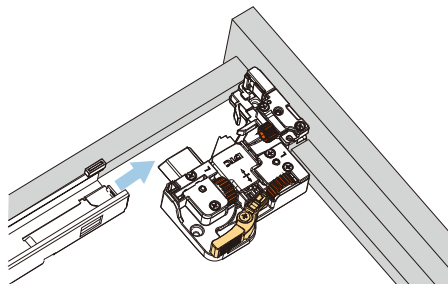

Adjustment

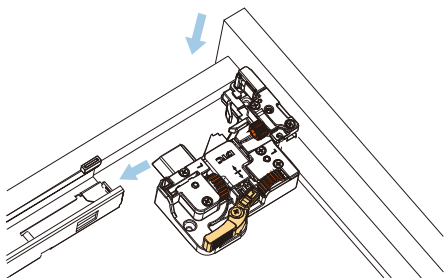

Up & down adjustment

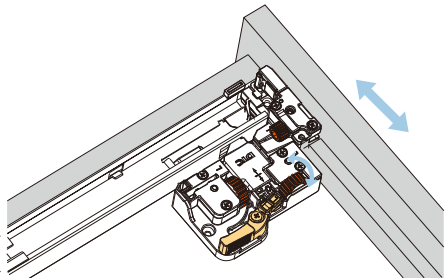

Side adjustment

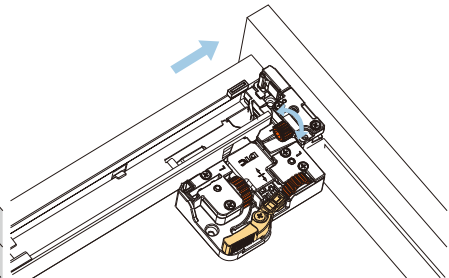

Depth adjustment

Removal

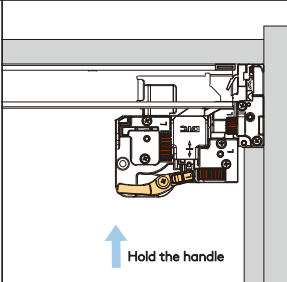

Pull-out

