

look inside

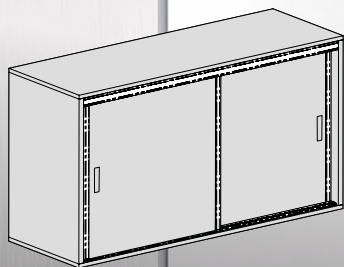

nikpol

dtc cs sliding door system
installation instructions



track-pro cs series soft-close sliding door system

Experience effortless door operation with a patented damper design ensuring smooth opening and closing. A reliable catching mechanism prevents disengagement, while the double-roller damper trigger enhances stability and smooth movement. The bottom roller's unique eccentric disc design allows for efficient height adjustments, with 15mm sprung and 5mm eccentric adjustments, totaling 20mm. Guiding rollers offer stepless adjustments from 35-39mm, and the damper trigger height can be fine-tuned up to 6mm for precise alignment.

cs two-way soft-close, surface-mount bottom roller, for wood door 10-24mm thick

cs series soft-close sliding door system

Code	Door Weight (KG)	Set/ctn
DTCWCS005A	5~15	10
DTCWCS005B	15~30	10
DTCWCS005C	30~50	10

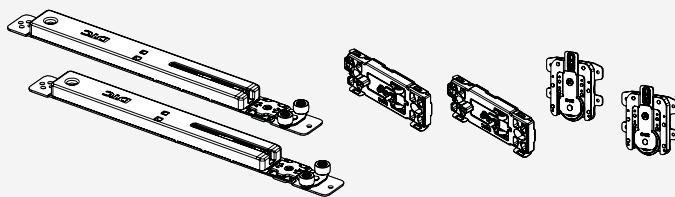

kit package includes

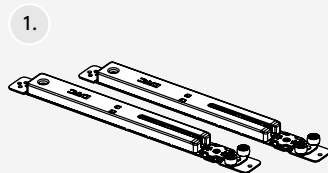
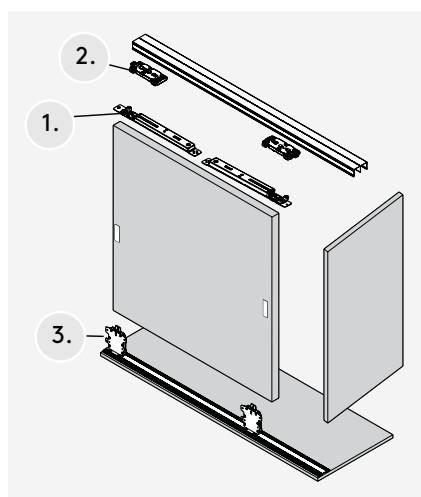

2 x damper

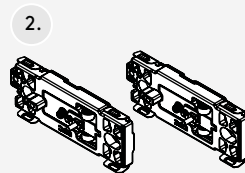

2 x damper trigger

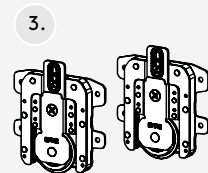

2 x surface-mount
bottom roller

sliding door installation dimensions (mm)

H = wardrobe internal height
h = door height
LT = wardrobe internal depth
T = door thickness

Wardrobe internal depth:

LT = 97(min)

Door height: $h = H - 43$

Door thickness: T = 10~24

Distance from door bottom to bottom track surface: 1.5~16.5

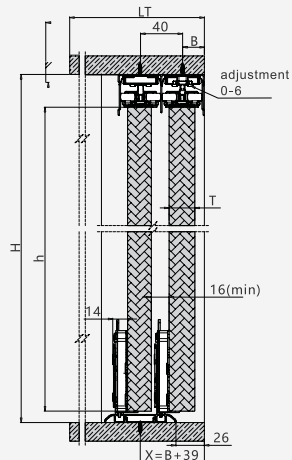

damper trigger installation dimensions (mm)

A = Distance from vertical door frame to head of damper

S = Damper trigger fixing position

S = A + 109

Door self closing distance K = 50

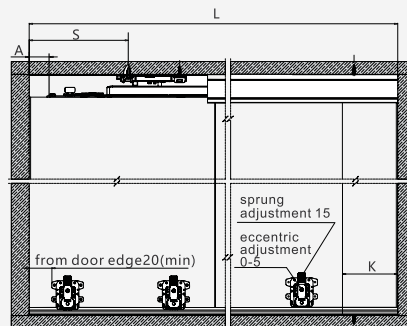

bottom track installation dimensions (mm)

Bottom Track

Silver

Code: DTCWCSDG02

Pcs/ctn: 10

Length: 6m

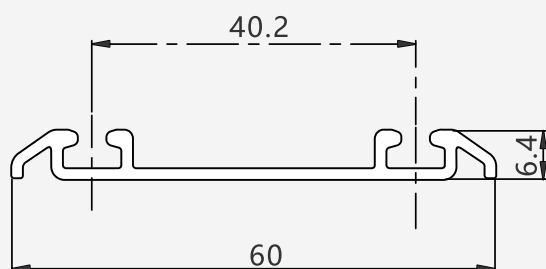

top track installation dimensions (mm)

Top Track

Silver

Code: DTCWCSDG01

Pcs/ctn: 5

Length: 6m

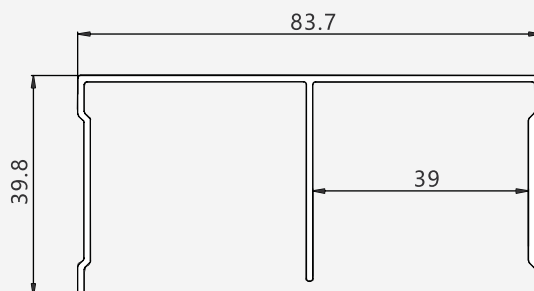

sliding door installation dimensions (mm)

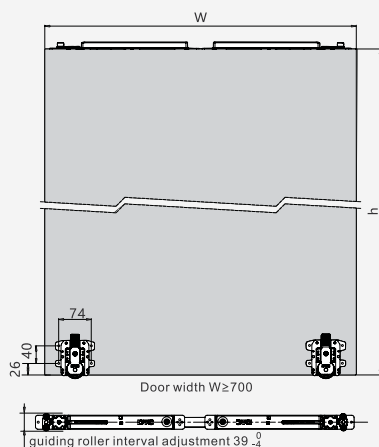

W = door width
 $W = L/2 + 15$
L = wardrobe internal width

assembly and adjustment

CS series installation for wood door

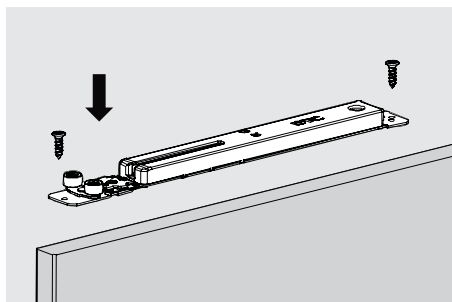

1. Install damper

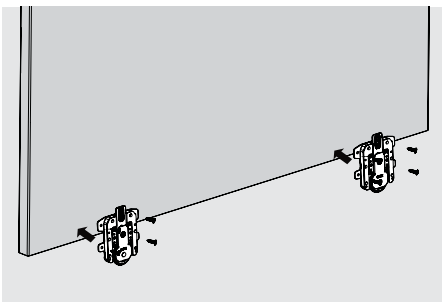

2. Install surface-mount bottom roller

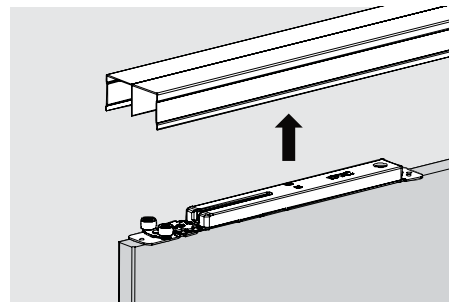

3. Mount the door

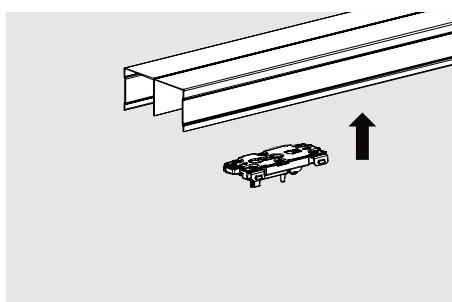

4. Install damper trigger

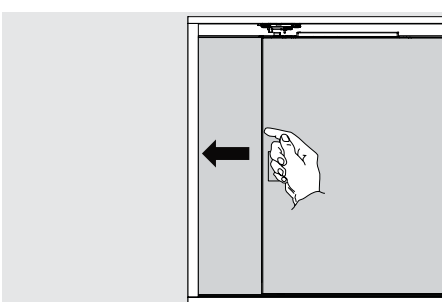

5. Push the door to the fully close position and locate the position for the damper trigger

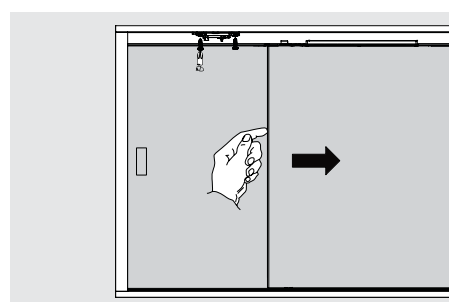

6. Pull the door open, then fix the damper trigger with screws

CS series adjustment

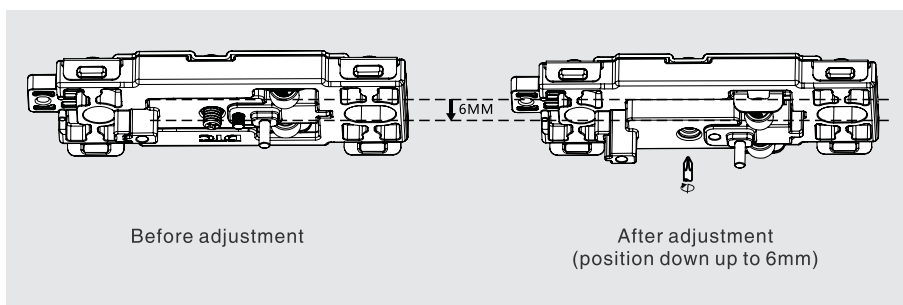

Damper trigger adjustment

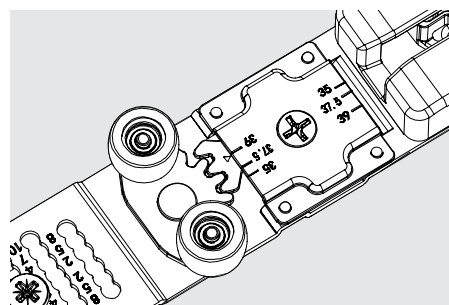

Guiding roller interval adjustment 35-39mm

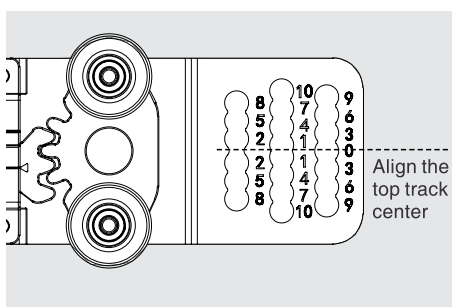

Having 0 as center, fix the screw according to door position

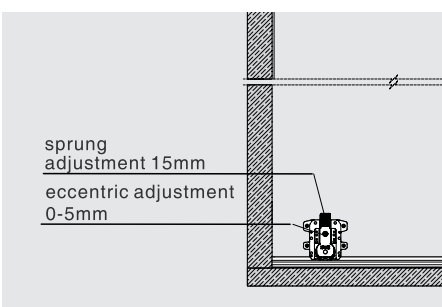

Bottom roller adjustment



Nikpol Pty. Ltd.

dtc cs sliding door system installation instructions

The colours shown in this flyer are an indication of the actual colour, for the most accurate colour-match sample, please visit the Nikpol website to order colour samples at www.nikpol.com.au

Tel 1300 645 765
Web www.nikpol.com.au
Email sales@nikpol.com.au

Head Office (VIC)
6-12 Fairchild Street
Heatherton VIC 3202

QLD
19 William Farrior Place
Eagle Farm QLD 4009