

STEP 5:

- a) Insert the screw on top T-Bar through key hole of front tube, then fasten the screw to frame.
- b) To adjust the door's lateral or horizontal position, loosen or tighten the screw set on bottom of T-Bar.
- c) To adjust the door's vertical position to use 2 adjustment bolts attached on bottom of frame.
- d) Using enclosed plastic clip (E) insert to pre-drilled holes in frame to get desired heights of basket.

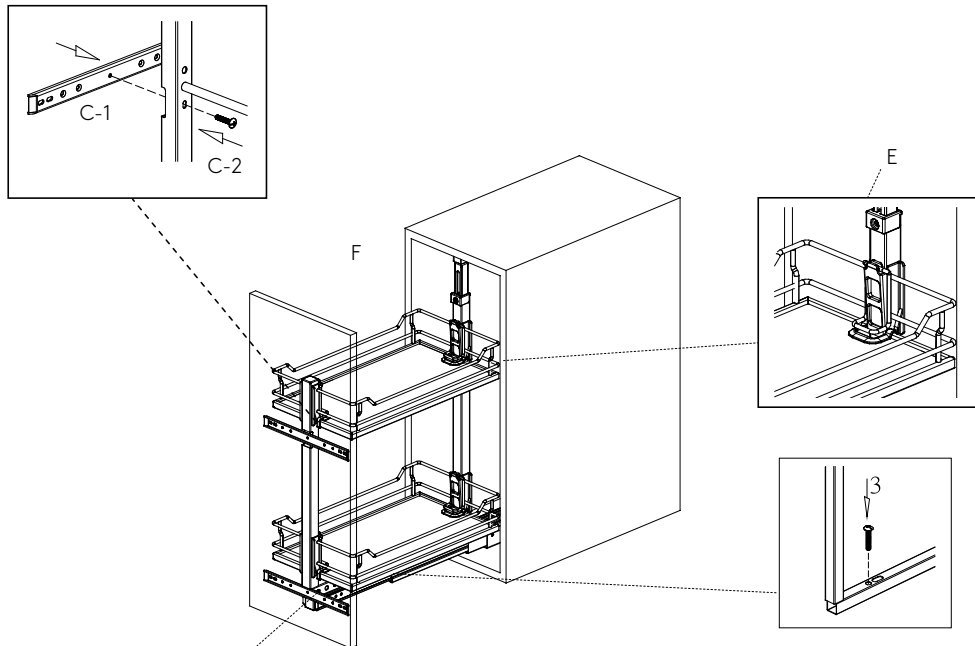

To adjust the door on vertical level.

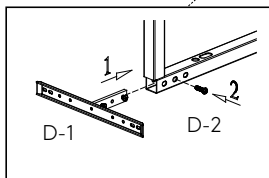

To adjust the door on lateral level.

OR

Hinge Door Type:

For Hinge Door Type, , drawing shows on below

